



**SECTION E CERTIFICATION**

This certification is to be signed by a land surveyor, engineer, or architect who is authorized by state or local law to certify elevation information when the elevation information for Zones A1-A30, AE, AH, A (with BFE), V1-V30, VE, and V (with BFE) is required. Community officials who are authorized by local law or ordinance to provide floodplain management information, may also sign the certification. In the case of Zones AO and A (without a FEMA or community issued BFE), a building official, a property owner, or an owner's representative may also sign the certification.

Reference level diagrams 6, 7 and 8 - Distinguishing Features-If the certifier is unable to certify to breakaway/non-breakaway wall, enclosure size, location of servicing equipment, area use, wall openings, or unfinished area Feature(s), then list the Feature(s) not included in the certification under Comments below. The diagram number, Section C, Item 1, must still be entered.

*I certify that the information in Sections B and C on this certificate represents my best efforts to interpret the data available.  
I understand that any false statement may be punishable by fine or imprisonment under 18 U.S. Code, Section 1001.*

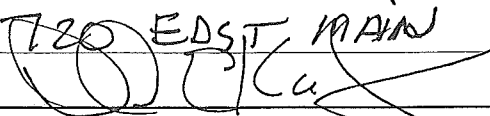
CERTIFIER'S NAME DAVID E. KATZUR LICENSE NUMBER (or Affix Seal) 30606  
 TITLE LAND SURVEYOR COMPANY NAME \_\_\_\_\_  
 ADDRESS 1720 EDST MAIN CITY PuyALLUP STATE WA. ZIP 98372  
 SIGNATURE  DATE 9/21/98 PHONE 253-845-8833

Copies should be made of this Certificate for: 1) community official, 2) insurance agent/company, and 3) building owner.

COMMENTS: USED RM 7 ON FIRM MAP 530143-001  
SPIKE IN POWER POLE #8/21 LOCATED APPROX 40 FT  
SOUTHWEST OF DEEDED ST. ON WEST SIDE  
OF CALISTOGA ST EL. = 190.91

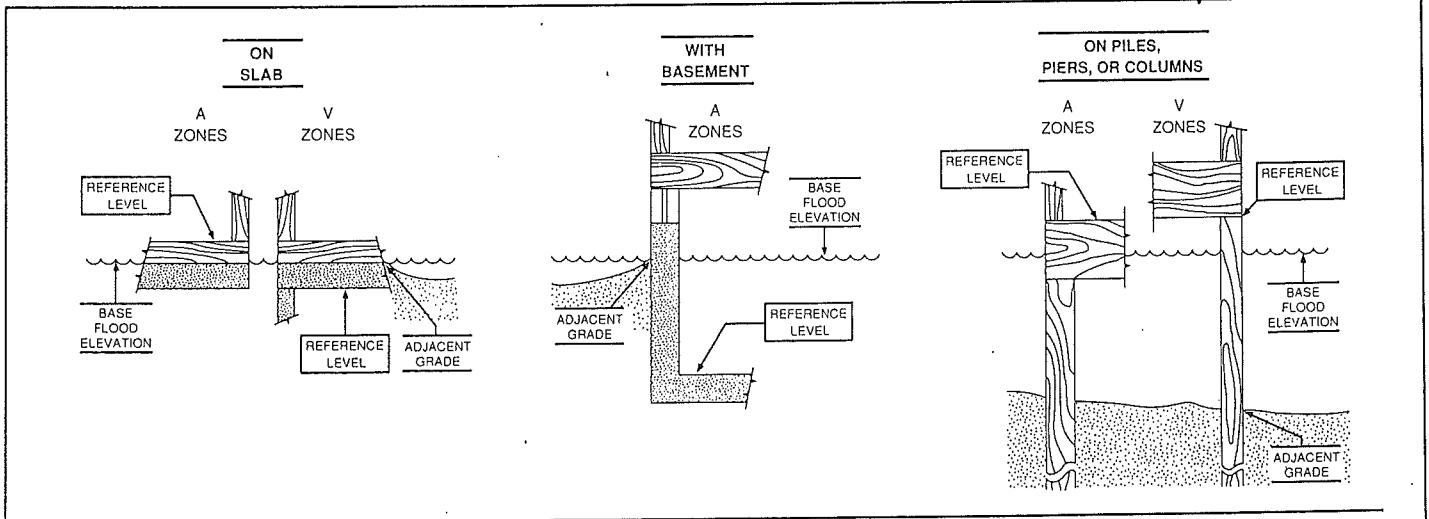
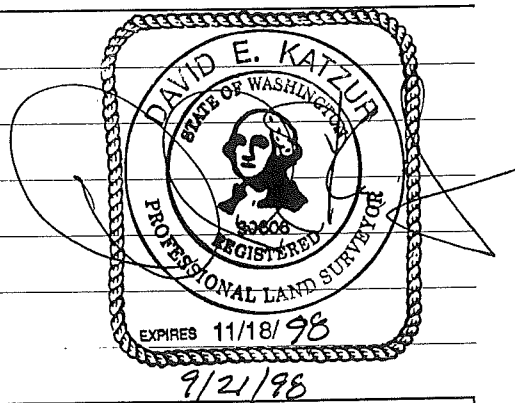

The diagrams above illustrate the points at which the elevations should be measured in A Zones and V Zones.  
 Elevations for all A Zones should be measured at the top of the reference level floor.  
 Elevations for all V Zones should be measured at the bottom of the lowest horizontal structural member.